

Government of West Bengal

District committee for competitive Bidding District- Paschim Medinipur

Notice for Inviting e-auction for Sand Mining Blocks Participating e-auction portal:

<https://eauction.gov.in/eAuction/app>

The following documents are to be uploaded for participating in e-auction:

- i. Photocopy of residential proof(Aadhar/voter card etc) with self attestation .
 - ii. Photocopy of PAN card with self attestation .
 - iii .Mining dues clearance certificate for existing mining lease holder(s)/ Affidavit as regard mining dues for the fresh applicant.
 - iv. Scan copy of EMD as specified for a particular sand mining block as referred in annexure-Y. Separate EMD for more than one sand block is to be submitted separately.
- photocopies of one set of aforesaid four documents (**Bank Draft/Bankers cheque in original**) also have to be dropped at least two hour prior to " document/ payment approval start time" in the drop box that to be kept in the Minor Mineral Section of the District HQ & to be opened prior to necessary approval meant for participating in bidding process.

The copy of this Bid document is available on the website
<https://www.paschimmedinipur.gov.in> & zpmidwest.org

Contents

1.Important information.....	3.
2.Definition.....	4.
3.Introduction.....	5.
4.The Concession Area.....	5.
5.Eligibility.....	6.
6.Review period & site visit.....	6.
7.Bidding Process.....	6.
8.Reserve Price.....	6.
9.Declaration of successful Bidding & grant of mining lease....	6.
9.1.Issuance of letter of intent.....	6 .
9.2.Continuation as a successful Bidder.....	6.
9.3.Grant of Mining lease.....	6.
10.General conditions regarding Bidding process.....	7.
10.1.Language.....	7.
10.2.Documents & information.....	7.
10.3.Overriding effect.....	7.
10.4Cost of Bidding.....	7.
10.5Verification by the State Govt. & disqualification.....	7.
10.6.Amendment of Bid document.....	8.
10.7.Rejection of Bids.....	8.
11.Earnest Money.....	8.
12.Fraud and corrupt practices.....	9.
13.Other provisions.....	9.
13.1.Governing law.....	9.
13.2.Right of State Govt./District Committee.....	9
13.3.Manner of conduction e- auction process.....	9.

1. Important information.

- 1.1 This Bid Documents has been issued pursuant to notification of area as specified in "Form A" for sand mining block in "Annexure - X" with intent to carry out e-auction through competitive bidding for grant of a mining lease for mineral specified herein pursuant to the Act and the rules made there under .Concession is to be granted for five years having area as mentioned in "annexure-X". All information provided in this Bid Document should be read together with the Act and the rules made there under. In the event of a conflict between this Bid Document and the Act or the rules, the Act or the rules, as the case may be, shall prevail.
- 1.2 The information contained in this Bid Document or subsequently provided to Bidder(s), whether verbally or in documentary or any other form by or on behalf of the State Government or any of its employees or advisors, is provided to Bidder(s) on the terms and conditions set out in this Bid Document.
- 1.3. This Bid Document is neither an agreement nor an offer by the State Government/District Committee to the prospective Bidders or any other person. The purpose of this Bid Document is to provide interested parties with information that may be useful to them in making their bids pursuant to this Bid Document. This Bid Document includes statements which reflect various assumptions and assessments arrived at by the State Government/ District Committee in relation to the mineral block. Such assumptions, assessments and statements do not purport to contain all the information that each Bidder may require. The assumptions, assessments, statements and information contained in the Bid Document may not be adequate, accurate and complete in all respect. Each Bidder should, therefore, conduct its own investigations and analysis and should check the accuracy, adequacy, correctness, reliability and completeness of the assumptions,

assessments, statements and information contained in this Bid Document and obtain independent advice from appropriate sources.

1.4. Information provided in this Bid Document to the Bidder(s) has been collated from several sources some of which may depend upon interpretation of Applicable Law. The information given is not intended to be an exhaustive account of statutory requirements and should not be regarded as exhaustive and complete in all respect. The State Government / District Committee accepts no responsibility for the accuracy or otherwise for any statement / data contained in this Bid Document.

1.5. The State Government / District Committee, its employees and advisors make no representation or warranty and shall have no liability to any person, including any Bidder under any law, statute, rules or regulations or tort. principles of restitution or unjust enrichment or otherwise for any loss, damages, cost or expense which may arise from or be incurred or suffered on account of anything contained in this Bid Document or otherwise, including the accuracy, adequacy, correctness, completeness or reliability of the Bid Document and any assessment, assumption, statement or information contained therein or deemed to form part of this Bid Document or arising in any way from participation in this Bid process.

1.6. The State Government/ District Committee may in its absolute discretion, but without being under any obligation to do so, update, amend or supplement the information, assessment or assumptions contained in this Bid Document.

1.7. The issue of this Bid Document does not imply that the State Government is bound to select a Bidder as Successful Bidder for the mineral block and the State Government / District Committee reserves the right to reject all or any of the Bidders or bids without assigning any reason whatsoever.

1.8. Each Bidder shall bear all its costs associated with or relating to the preparation and submission of its bid including but not limited to preparation, copying, postage, delivery fees, expenses associated with any demonstrations or presentations which may be required by the State Government/ District Committee or any other costs incurred in connection with or relating to its bid.

1.9. This Bid Document is not transferable.

2. Definitions

The words and expressions used herein but not defined herein shall have the same meaning as assigned to them in the Act or the rules made there under. The following definitions apply to this Bid Document, unless the context otherwise requires:

2.1. "**Act**" means the Mines and Minerals (Development and regulation) Act, 1957 (as amended).

2.2. "**Applicable Law**" shall mean all applicable statutes, laws, by-laws, rules, regulations, orders, ordinances, protocols, codes, guidelines, policies, notices, directions, judgments, decrees or other requirements or official directive of any governmental authority or court or other law, rule or regulation approval from the relevant governmental authority, government resolution, directive, or other government restriction or any similar form of decision of, or determination by, or any interpretation or adjudication having the force of law in India.

2.3. "**Auction Rules**" means the West Bengal Minor Mineral (Auction) Rules, 2016.

2.4. "**Bidder**" means a person who has purchased/downloaded this Bid Document and intends to participate in the e-auction process of minor minerals.

2.5. "**Concession Area**" means *particulars of the area* as more particularly described in Form A of West Bengal Minor Minerals (Auction) Rules, 2016.

2.6. "**Performance Security**" means a bank guarantee as provided in rule 11 of the West Bengal Minor Minerals (Auction) Rules (henceforth mentioned as Auction Rules).

2.7. "**State Government**" means Government of West Bengal.

2.8. "**Bid Document**" means this Bid document with addenda, if any, to this Bid Document.

Note: Words and expressions used and not defined in this Bid Document but defined in the Act and rules made there under shall have the same meanings as respectively assigned to them in the Act or rules made there under.

3. Introduction

3.1. In exercise of powers conferred by the section 15 of the Act, the State Government has notified the West Bengal Minor Mineral(Auction) Rules, 2016. The Bidders are encouraged to acquaint themselves with the Act and the rules made there under.

3.2. This Bid Document is being issued by the State Government / District Committee, for e-auction through competitive bidding for grant of a mining lease over the Concession Area.

3.3. The e-auction would be conducted in accordance with the Act, the Auction Rules, any other order or notification issued by the State Government/District Committee pursuant to the Act and this Bid Document.

4. The Concession Area

The information regarding the Concession Area is available In Form A as well as in "Annexure -X" provided with e-auction notice.

5. Eligibility

(a) Eligibility of bidders for minor minerals shall be as prescribed in rule 4 of West Bengal Minor Mineral Concession Rules, 2016 and rule 6 of Auction Rules.

(b) Up to date mining dues clearance certificate is to be furnished by the existing lease holder. In case of fresh Bidder an affidavit is to be furnished regarding mining dues.

(c) The eligibility conditions shall be used only for the purposes of determination of eligibility for participating in the e-auction. The Successful Bidder shall be decided solely on the basis of Bid Amount as submitted by at least three eligible Bidders after approval of participants.

6. Review period and site visit

6.1. Pursuant to sub-rule (3) of Rule 9 of the Auction Rules, the Bidders shall be provided a fixed period as mentioned in Annexure "Z" to study the Bid Document and the bidding process shall commence only after such period .

6.2. Such period of days would commence on **03.01.2017** and would end on **10.01.2017** In this connection critical dates are shown in separate attached "Annexure - Z" .

6.3. During such period the Bidders may undertake the site visit to Concession Area at their own cost and risk to ascertain for themselves the site conditions, location, communication, climate, availability of power, and any other matter considered relevant by them.

6.4. The site visit to the Concession Area shall be conducted with prior notice to the State Government/District Committee through the following email address – dllro.mid@gmail.com

7. Bidding process

Pursuant to Rule 9 of the Auction Rules, the e-auction shall be an ascending forward online electronic auction. The manner of conduction of e-auction has been prescribed in rule 9 of Auction Rules.

8. Reserve Price

The Reserve Price has been mentioned against block within "Annexure -Y" as per rule - 8 of Auction rules , 2016 and as prescribed by the district committee.

9. Declaration of Successful Bidder ,and grant of mining lease

Pursuant to Rule 9 of the Auction Rules, the mining lease shall be granted to the Successful Bidder in the following manner:

9.1. Issuance of letter of intent:

In terms of Rule 10 of the Auction Rules, a Grant Order/ Letter of Intent (LoI) shall be issued by the State Government/District Committee to the Successful Bidder upon payment of the first installment of the Bid Amount which is one third of total Bid amount as declared / reported by successful Bidder against enlisted sand mining block as referred in "Annexure -Y".

9.2. Continuation as a successful Bidder

The "**Successful Bidder**" shall remain so -

(a) Continuing to be in compliance with all the terms and conditions of eligibility and Grant Order/LoI:

(b) Payment of the first installment of the Bid Amount which is one third of the Bid amount as offered by the successful Bidder.

(c) Furnishing the Performance Security pursuant to the Auction Rules

(d) Furnishing undertaking for payment of the balance Bid Amount as prescribed in rule 10 of West Bengal Minor Mineral (Auction) Rules, 2016. The balance amount to be paid within two equal installments before the execution of lease deed as referred in "Annexure Y".

(e) Furnish undertaking for payment towards preparation of PFR, Form-I M and Mine Plan, if the same has already been made prepared by the District Committee, as an exercise of facilitation to the prospective lessee(s).

9.3. Grant of Mining Lease

Subsequent to selection of the Successful Bidder and compliance of the conditions as stated in G.O/LoI, Bidder shall pay the second installment of the Bid Amount as offered by the successful Bidder against a sand mine block . Upon such payment the District Authority shall execute the mining lease deed to the Successful Bidder within a period of 30 days from the date of payment. The date of the commencement of the period for which the mining lease deed is executed shall be the date on which a duly executed mining lease is registered.

10. General Conditions regarding Bidding Process

10.1. Language

The Bid and all communications in relation to or concerning the Bid Document and the Bid are required to be in the English language.

10.2. Documents an information

The documents including this Bid Document and all attached documents. provided by the State Government/District Committee are and shall remain or become the properties of the State Government/ District Committee. Bidders are required to treat all such information as strictly confidential and shall not use it for any purpose other than for preparation and submission of their bid. The provisions of this Clause shall also apply to bids and all other documents submitted by the Bidders in relation to the bid, and the State Government/District Committee will not return to the Bidders any bid, document or any information provided along therewith.

10.3. Overriding effect

If there is a conflict between this Bid document and LoI/ G.O or mining lease deed , the LoI/ G.O or mining lease deed shall prevail over the Bid document .

10.4. Cost of Bidding

The Bidders shall be responsible for all of the costs associated with the preparation of their bids and their participation in the Bidding process. The State Government will not be responsible or in any way liable for such costs, regardless of the conduct or outcome of the Bidding process.

10.5. Verification by the state government and disqualification

10.5.1. The State Government/District Committee reserves the right to verify all statements, information and documents submitted by the Bidder in response to the Bid Document and Bidding and the Bidder shall, when so required by the State Government / District Committee , make available all such information, evidence and documents as may be necessary for such verification. Any such verification or lack of such verification by the State Government/ District Committee shall not relieve the Bidder of its obligations or liabilities hereunder nor will it affect any rights of the State Government/ District Committee there under.

10.5.2. The State Government / District Committee reserves the right to reject any bid, and appropriate the entire Earnest Money if:

- (a) At any time, a misrepresentation is made or uncovered,
- (b) The Bidder does not provide, within the time specified by the State Government/District Committee, the supplemental information sought by the State Government/ District Committee for evaluation of the bid, or
- (c) Any act or omission of the Bidder results in violation of or noncompliance with the Act, the rules there under, this Bid Document, or any other document referred therein or issued pursuant thereto or any Applicable Law relevant for the Bid process.

10.5.3. Any rejection of a bid under Clause 10.5.2 may lead to the disqualification of the Bidder for bidding for any e-auction or allotment conducted by the State Government / District Committee for a period of five years starting from the date of appropriation of the Earnest Money or any other earlier date specified by the State Government / District Committee.

10.5.4. In the aforementioned events, the State Government shall be entitled to forfeit and appropriate the Bid Security or Performance Security, as the case may be, without prejudice to any other right or remedy that may be available to the State Government / District Committee under the Bid Document, or otherwise, without any liability whatsoever.

10.6 Amendment of Bid Document

10.6.1. At any time prior to the Bid Due Date, the State Government! District Committee may, for any reason, whether at its own initiative or in response to clarifications requested by a Bidder, amend the Bid Document.

10.6.2. Any amendment issued hereunder will be in writing and shall be made available to in NIC portal and shall be deemed to be part of the Bid Document.

10.7. Rejection of Bid

10.7.1. Notwithstanding anything contained in this Bid Document, the State Government/ District Committee reserves the right to reject any bid and/or to annul the Bidding process and reject all bids at any time without any liability or any obligation for such acceptance, rejection or annulment, and without assigning any reasons thereof.

10.7.2. In case such cancellation is pursuant to non-compliance by the relevant Bidders vis-a-vis submissions of bid then the State Government/ District Committee reserves the right to appropriate the relevant Bid Security submitted by such non-compliant Bidders.

10.7.3. The State Government! District Committee reserves the right not to proceed with the Bidding process at any time, without notice or liability, and to reject any bid without assigning any reasons.

10.7.4. Without prejudice to the generality of the foregoing, the State Government/ District Committee reserves the right to reject any bid on any criteria specified in this Bid Document, including without limitation, the following:

- (a) Bids have not been submitted as per Bid Document.
- (b) Bid is not in conforming to the existing Act and rules made there under.
- (c) Bids have been submitted without Earnest Money or period of validity.

11. Earnest Money:

11.1. The Earnest Money shall be ten (10) percent of reserved price which has been specified against mining block as referred in "Annexure - Y" .It shall be in the form of Demand Draft/Banker's Cheque to be drawn in favor of the Additional District Magistrate and District Land & Land Reforms Officers , Paschim Medinipur , payable at Medinipur.

Earnest Money Deposited (EMD) will be forfeited against a particular sand block for the following cases:

- (a) If none from the approved participants takes part in Bidding process, EMDs of all approved participants will be forfeited.
- (b) If only two from the approved participants takes part in Bidding process, EMDs of others approved participants will be forfeited.
- (c) If only one from the approved participants takes part in Bidding process, EMDs of others approved participants will be forfeited.

11.2. Save and except as provided in this Bid Document, the Earnest Money of unsuccessful Bidders will be returned by the District Committee, without any interest, as promptly as possible.

11.3. The Successful Bidder's Earnest Money will be adjusted with the Bid Amount, without any interest, upon furnishing of the Performance Security in accordance with the provisions thereof performance security as referred in "Annexure -Y" to be paid prior to execution of deed.

11.4. The State Government/ District Committee shall be entitled to forfeit and appropriate the Earnest Money as damages, amongst others in any of the events specified in this Bid Document. The Bidder, by submitting its bid pursuant to this Bid Document, shall be deemed to have acknowledged and confirmed that the State Government / District Committee will suffer loss and damage on account of withdrawal of its bid or for any other default by the Bidder during the period of bid validity as specified in this Bid Document.

12. Fraud and Corrupt Practices

12.1. The Bidders and their respective officers, employees, agents and advisers shall observe the highest standard of ethics during the Bidding process and subsequent to the grant of the mining lease. Notwithstanding anything to the contrary contained herein, the State Government/ District Committee may reject a bid, withdraw the mining lease, as the case may be, without being liable in any manner whatsoever to the Bidder. The Successful Bidder, as the case may be, if the State Government/ District Committee determine that the Bidder, or Successful Bidder, as the case may be, has, directly or indirectly or through an agent, engaged in Corrupt Practice, Fraudulent Practice, Coercive Practice, Undesirable Practice or Restrictive Practice in the Bidding process, in such an event, the State Government/ District Committee shall be entitled to forfeit and appropriate the Earnest Money or Performance Security, as the case may be, as damages, without prejudice to any other right or remedy that may be available to the State Government/ District Committee under the Bid Document and/ or otherwise.

12.2. Without prejudice to the rights of the State Government / District Committee hereinabove stated and the rights and remedies which the State Government/ District Committee may have under the mining lease or otherwise if a Bidder, Successful Bidder, as the case may be, is found by the State Government/ District Committee to have directly or indirectly or through an agent, engaged or indulged in any Corrupt Practice, Fraudulent Practice, Coercive Practice, Undesirable Practice or Restrictive Practice during the Bidding process, or after the grant of the mining lease, such Bidder or successful Bidder shall not be eligible to participate in any Bid / Tender or Tender Document issued by the State Government/ District Committee during a period of five years from the date such Bidder or Successful Bidder, as the case may be, is found by the State Government to have directly or indirectly or through an agent, engaged or indulged in any Corrupt Practice, Fraudulent Practice, Coercive Practice, Undesirable Practice or Restrictive Practices, as the case may be.

13. Other provisions

13.1. Governing law

The Bidding process shall be governed by, and construed in accordance with, the laws of India.

13.2. Right of State Government/ District Committee

13.2.1. The State Government/ District Committee, in its sole discretion and without incurring any obligation or liability, reserves the right, at any time, to;

(a) suspend and/ or cancel the Bidding process and/or amend and/or supplement the Bidding process or modify the dates or other terms and conditions relating thereto;

(b) consult with any Bidder in order to receive clarification or further information;

(c) retain any information and/ or evidence submitted to the State Government / District Committee by, on behalf of, and/ or in relation to any Bidder; and/ or

(d) independently verify, disqualify, reject and/ or accept any and all submissions or other information and/ or evidence submitted by or on behalf of any Bidder.

13.2.2. It shall be deemed that by submitting the bid, the Bidder agrees and releases the State Government/ District Committee, its employees, agents and advisers, irrevocably, unconditionally, fully and finally from any and all liability for claims, losses, damages, costs, expenses or liabilities in any way related to or arising from the exercise of any rights and/ or performance of any obligations hereunder, pursuant hereto and/ or in connection with the Bidding process and waives, to the fullest extent permitted by Applicable Law, any and all rights and/or claims it may have in this respect, whether actual or contingent, whether present or in future.

13.3. Manner of Conduction of e-auction process

The e-auction process of minor mineral would be conducted in the national Informatics Centre portal namely <https://eauction.gov.in/eAuction/app>

Sd/-

District Magistrate & Chairman,
District Committee for competitive Bidding,
Paschim Medinipur.

Selected Mining blocks for e-auction (Annexure-'X').

Mining Block No	Land Particular (P.S, Mouza, J.L.,No. Plot No.	Location of Mining Block		Area (Hec)
		Latitude	Longitude	
M GARB 19	MOUZA – UCHALADANGA, J.L. No. – 507. PLOT NO-1(PART) P.S.-GARHBETA, DIST-PASCHIM MEDINIPUR.	22°52'15.63"N 22°52'14.44"N 22°52'16.01"N 22°52'17.01"N	87°19'4.81"E 87°19'4.50"E 87°19'0.56"E 87°19'0.84"E	0.43 hectare or 1.07 acre
M GARB 20	MOUZA – PAYRAURI, J.L. No. – 519. PLOT NO-1(PART) P.S.-GARHBETA, DIST-PASCHIM MEDINIPUR.	22°51'49.80"N 22°51'45.43"N 22°51'57.35"N 22°51'58.97"N	87°19'48.72"E 87°19'48.84"E 87°19'34.74"E 87°19'35.94"E	2.33 hectare or 5.75 acre
M GARB 21	MOUZA – DEULKALA, J.L. No. – 274. PLOT NO-488(PART) P.S.-GARHBETA, DIST-PASCHIM MEDINIPUR	22°50'12.00"N 22°50'11.06"N 22°50'16.37"N 22°50'17.46"N	87°14'37.25"E 87°14'36.63"E 87°14'29.16"E 87°14'29.68"E	0.73 hectare or 1.80 acre
M GARB 22	MOUZA – GANGANI, J.L. No. – 485. PLOT NO-1(PART) P.S.-GARHBETA, DIST-PASCHIM MEDINIPUR.	22°51'36.36"N 22°51'35.12"N 22°51'42.98"N 22°51'47.07"N	87°20'3.00"E 87°20'2.22"E 87°19'51.23"E 87°19'51.23"E	2.38 hectare or 5.89 acre
M GARB 23	MOUZA – GANGANI, J.L. No. – 485. PLOT NO-1(PART) P.S.-GARHBETA, DIST-PASCHIM MEDINIPUR	22°51'35.96"N 22°51'34.89"N 22°51'34.12"N 22°51'35.87"N	87°20'22.01"E 87°20'22.07"E 87°20'4.01"E 87°20'5.16"E	2.95 hectare or 7.28 acre
M GARB 24	MOUZA – BHATTAGRAM, J.L. No. – 399. PLOT NO-680(P) P.S.-GARHBETA, DIST-PASCHIM MEDINIPUR.	22°51'10.77"N 22°51'9.13"N 22°51'3.39"N 22°51'5.38"N	87°17'17.83"E 87°17'19.79"E 87°17'14.54"E 87°17'11.25"E	2.30 hectare or 5.70 acre
M GARB 25	MOUZA – BHATTAGRAM, J.L. No. – 399. PLOT NO-680(P) P.S.-GARHBETA, DIST-PASCHIM MEDINIPUR.	22°51'13.92"N 22°51'13.29"N 22°51'10.33"N 22°51'12.31"N	87°17'25.79"E 87°17'26.16"E 87°17'21.37"E 87°17'20.09"E	0.80 hectare or 1.98 acre
M GARB 26	MOUZA – LAKSHYATAPAL, J.L. No. – 937. PLOT NO-1381(P) P.S.-GARHBETA, DIST-PASCHIM MEDINIPUR.	22°52'36.30"N 22°52'28.51"N 22°52'27.86"N 22°52'36.45"N	87°24'13.97"E 87°24'12.34"E 87°24'10.56"E 87°24'13.51"E	1.08 hectare or 2.67 acre
M GARB 27	MOUZA – LAKSHYATAPAL, J.L. No. – 937. PLOT NO-1382(P) P.S.-GARHBETA, DIST-PASCHIM MEDINIPUR.	22°52'26.35"N 22°52'19.75"N 22°52'19.23"N 22°52'25.89"N	87°24'12.60"E 87°24'18.10"E 87°24'17.71"E 87°24'11.01"E	0.78 hectare or 1.93 acre

M GARB 28	MOUZA – BHAGAR DANGA, J.L. No. – 366.PLOT NO-72(P) P.S.-GARHBETA, DIST-PASCHIM MEDINIPUR.	22°50'13.80"N 22°50'13.39"N 22°50'4.27"N 22°50'5.05"N	87°15'21.30"E 87°15'21.98"E 87°15'11.18"E 87°15'10.40"E	0.98 hectare or 2.42 acre
--------------	--	--	--	---------------------------------

PAYMENT DETAILS (Annexure-‘Y’) :

Mining Block	Land Particular (P.S, Mouza, J.L,No. Plot No.	Reserve Price (in Rs)	Earnest Money (in Rs)	Mode of Payment of Bid amount within	Amount of performance security (in Rs)
M GARB 19	MOUZA – UCHALADANGA, J.L. No. – 507. PLOT NO-1(PART) P.S.-GARHBETA, DIST-PASCHIM MEDINIPUR.	53763	5376	1/3- Within 15 days and balance amount in two equal installment before execution of lease.	10% of Bid amount in the form of Bank Guarantee.
M GARB 20	MOUZA – PAYRAURI, J.L. No. – 519. PLOT NO-1(PART) P.S.-GARHBETA, DIST-PASCHIM MEDINIPUR.	291255	29126		
M GARB 21	MOUZA – DEULKALA, J.L. No. – 274. PLOT NO-488(PART) P.S.-GARHBETA, DIST-PASCHIM MEDINIPUR	91259	9126		
M GARB 22	MOUZA – GANGANI, J.L. No. – 485. PLOT NO-1(PART) P.S.-GARHBETA, DIST-PASCHIM MEDINIPUR.	297508	29751		
M GARB 23	MOUZA – GANGANI, J.L. No. – 485. PLOT NO-1(PART) P.S.-GARHBETA, DIST-PASCHIM MEDINIPUR	368761	36876		
M GARB 24	MOUZA – BHATTAGRAM, J.L. No. – 399. PLOT NO-680(P) P.S.-GARHBETA, DIST-PASCHIM MEDINIPUR.	287505	28751		
M GARB 25	MOUZA – BHATTAGRAM, J.L. No. – 399. PLOT NO-680(P) P.S.-GARHBETA, DIST-PASCHIM MEDINIPUR.	100015	10002		
M GARB 26	MOUZA – LAKSHYATAPAL, J.L. No. – 937. PLOT NO-1381(P) P.S.-GARHBETA, DIST-PASCHIM MEDINIPUR.	135008	13501		
M GARB 27	MOUZA – LAKSHYATAPAL, J.L. No. – 937. PLOT NO-1382(P) P.S.-GARHBETA, DIST-PASCHIM MEDINIPUR.	97501	9750		
M GARB 28	MOUZA – BHAGAR DANGA, J.L. No. – 366.PLOT NO-72(P) P.S.-GARHBETA, DIST-PASCHIM MEDINIPUR.	122513	12251		

Critical Dates (Annexure-Z)

Sl.No	Item	DD	MM	YYYY	Hrs	Mins
01.	Publish date	03	01	2017	09	00
02.	Document Submission/Payment Start Date	03	01	2017	09	00
03.	Document Submission/Payment End Date	10	01	2017	09	00
04.	Document/Payment Approval Start Date	11	01	2017	09	00
05.	Document/Payment Approval End Date	13	01	2017	09	00
06.	Auction Start Date	13	01	2017	13	00
07.	Auction End Date	15	01	2017	13	00
08	Auto Extension time.	Five (05) minutes.				

FORM – A
MGAR-B-19

[See sub-rule (1) of rule 9 of West Bengal Minor Minerals (Auction) rules, 2016]

Mining Lease Area (in Ha)	: Proposed area – 0.43 hectare or 1.07 acre Permissible working area – 0.43 ha (4300sqm) MGAR-B –19 (Area reduce due to Sub rule 6 of Rule 3 of W.B. MMCR/2016)	
Location of Mine (Centre)with coordinate: Location Mouza, Block, P.S. and GIS coordinates (Latitude & Longitude)of the central Axis of the mining area.	Latitude	Longitude
	22°52'15.63"N	87°19'4.81"E
	22°52'14.44"N	87°19'4.50"E
	22°52'16.01"N	87°19'0.56"E
	22°52'17.01"N	87°19'0.84"E
	Mouza- Uchaladanga , JL no - 509,Plot no – 1(P), P.S-Garhbeta, Dist-Paschim Medinipur.	
River/Canal/Khal	: Silabati River	
Topography	: Silabati River sand mining lease area covers almost a flat region. The width of the river bank varies from 15m – 35m. There is no Bridge, Dam, Hydraulic structures, railways, embankments within500 m. The other details are mentioned in the mining plan.	
Minerals of mine	: Ordinary river sand mining	
Total mineral reserves(Cum/Annum)	1. Geological Reserve in cum: 12900 Cum / Year 2. Permissible / Minerable reserve in cum : 2150 3. Production / replacement of sand in Cum per year : 2150 Cum	
Life of mine	: Thedeposition in the river bed is a regular phenomenon depends on quantum of water and the flow rate of river which varies with quantity of precipitation along the riverbed and in the catchment area also. The major portion of precipitation occurs during the monsoon period/ season i.e June to September in every year. The sand gets carried out from the upper stream of the river along the riverbed and deposited all along the riverbed, as soon as the river water current subsides. The deposit of sand is a cyclic and replenishable activity of the nature. Statutory lease can be granted upto 10 Years.	
Method of mining	: Manual	
Drilling/ Blasting	: No	
Water demand	: 3 KLD	
Sources of water	: Tube well	
Ultimate depth of Mining	: 1.5m - 2m	
Average Man Power per day	: Category of Person Required Based on Proposed	
	Activiwise Mazdoor	No

	Sand Loading Mazdoor	20
	Sand Scraping Mazdoor	10
	Tipper Operation	2
	Tipper Helper	2
	Munshi/ Clark	2
	Total	36
Solid Waste including residual riverbed materials	: Nil	
Nearest Railway Station	: Chandrakana Road Railway Station -18.43Km (Aerial) (NW)	
Nearest State Highway/ National Highway	: NH-6 – 13.11 KM (Aerial) (W)	
Nearest Airport	NSCB (Kolkata)-101 km(Aerial) (SE)	
Protected /Reserve forest	There is no reserve forest present within 5 km.	

Prepared by:

Ultratech Environment Consultancy & laboratory

**ULTRA-TECH Environmental
Consultancy & Laboratory**
Kolkata Branch
Lab Gaztted by-MoEF-Govt. of India
An ISO 9001:2008 Certified Company
CG-229, Salt Lake Sector-II
Kolkata - 700091

FORM – A
MGAR-B-20

[See sub-rule (1) of rule 9 of West Bengal Minor Minerals (Auction) rules, 2016]

Mining Lease Area (in Ha)	: Proposed area – 2.33 hectare or 5.75 acre Permissible working area –2.33 ha (23300sqm) MGAR-B –20 (Area reduce due to Sub rule 6 of Rule 3 of W.B. MMCR/2016)	
Location of Mine (Centre)with coordinate: Location Mouza, Block, P.S. and GIS coordinates (Latitude & Longitude)of the central Axis of the mining area.	Latitude	Longitude
	22°51'49.80"N	87°19'48.72"E
	22°51'45.43"N	87°19'48.84"E
	22°51'57.35"N	87°19'34.74"E
	22°51'58.97"N	87°19'35.94"E
	Mouza- Payrauri , JL no - 519,Plot no – 1(P), P.S- Garhbeta, Dist-Paschim Medinipur.	
River/Canal/Khal	: Silabati River	
Topography	: Silabati River sand mining lease area covers almost a flat region. The width of the river bank varies from 15m – 35m. There is no Bridge, Dam, Hydraulic structures, railways, embankments within500 m. The other details are mentioned in the mining plan.	
Minerals of mine	: Ordinary river sand mining	
Total mineral reserves(Cum/Annum)	4. Geological Reserve in cum: 69900 Cum / Year 5. Permissible / Minerable reserve in cum : 11650 6. Production / replacement of sand in Cum per year : 11650 Cum	
Life of mine	: The deposition in the river bed is a regular phenomenon depends on quantum of water and the flow rate of river which varies with quantity of precipitation along the riverbed and in the catchment area also. The major portion of precipitation occurs during the monsoon period/ season i.e June to September in every year. The sand gets carried out from the upper stream of the river along the riverbed and deposited all along the riverbed, as soon as the river water current subsides. The deposit of sand is a cyclic and replenishable activity of the nature. Statutory lease can be granted upto 10 Years.	
Method of mining	: Manual	
Drilling/ Blasting	: No	
Water demand	: 3 KLD	
Sources of water	: Tube well	
Ultimate depth of Mining	: 1.5m - 2m	
Average Man Power per day	: Category of Person Required Based on Proposed	
	Activiwise Mazdoor	No

	Sand Loading Mazdoor	20
	Sand Scraping Mazdoor	10
	Tipper Operation	2
	Tipper Helper	2
	Munshi/ Clark	2
	Total	36
Solid Waste including residual riverbed materials	: Nil	
Nearest Railway Station	: Chandrakana Road Railway Station -18.43Km (Aerial) (NW)	
Nearest State Highway/ National Highway	: NH-6 – 13.11 KM (Aerial) (W)	
Nearest Airport	NSCB (Kolkata)-101 km(Aerial) (SE)	
Protected /Reserve forest	There is no reserve forest present within 5 km.	

Prepared by:

 Ultratech Environment Consultancy & laboratory

ULTRA-TECH Environmental
Consultancy & Laboratory
Kolkata Branch
Lab Gaztted by-MoEF-Govt. of India
An ISO 9001:2008 Certified Company
 CG-229, Salt Lake Sector-II
 Kolkata - 700091

FORM – A
MGAR-B-21

[See sub-rule (1) of rule 9 of West Bengal Minor Minerals (Auction) rules, 2016]

Mining Lease Area (in Ha)	: Proposed area – 0.73 hectare or 1.80 acre Permissible working area –0.73 ha (7300sqm) MGAR-B –21 (Area reduce due to Sub rule 6 of Rule 3 of W.B. MMCR/2016)	
Location of Mine (Centre)with coordinate: Location Mouza, Block, P.S. and GIS coordinates (Latitude & Longitude)of the central Axis of the mining area.	Latitude	Longitude
	22°50'12.00"N	87°14'37.25"E
	22°50'11.06"N	87°14'36.63"E
	22°50'16.37"N	87°14'29.16"E
	22°50'17.46"N	87°14'29.68"E
	Mouza- Deulkala , JL no - 274,Plot no – 488(P), P.S- Garhbeta, Dist-Paschim Medinipur.	
River/Canal/Khal	: Silabati River	
Topography	: Silabati River sand mining lease area covers almost a flat region. The width of the river bank varies from 15m – 35m. There is no Bridge, Dam, Hydraulic structures, railways, embankments within500 m. The other details are mentioned in the mining plan.	
Minerals of mine	: Ordinary river sand mining	
Total mineral reserves(Cum/Annum)	7. Geological Reserve in cum: 21900 Cum / Year 8. Permissible / Minerable reserve in cum : 3650 9. Production / replacement of sand in Cum per year : 3650 Cum	
Life of mine	: The deposition in the river bed is a regular phenomenon depends on quantum of water and the flow rate of river which varies with quantity of precipitation along the riverbed and in the catchment area also. The major portion of precipitation occurs during the monsoon period/ season i.e June to September in every year. The sand gets carried out from the upper stream of the river along the riverbed and deposited all along the riverbed, as soon as the river water current subsides. The deposit of sand is a cyclic and replenishable activity of the nature. Statutory lease can be granted upto 10 Years.	
Method of mining	: Manual	
Drilling/ Blasting	: No	
Water demand	: 3 KLD	
Sources of water	: Tube well	
Ultimate depth of Mining	: 1.5m - 2m	
Average Man Power per day	: Category of Person Required Based on Proposed	
	Activiwise Mazdoor	No

	Sand Loading Mazdoor	20
	Sand Scraping Mazdoor	10
	Tipper Operation	2
	Tipper Helper	2
	Munshi/ Clark	2
	Total	36
Solid Waste including residual riverbed materials	: Nil	
Nearest Railway Station	: Chandrakana Road Railway Station -18.43Km (Aerial) (NW)	
Nearest State Highway/ National Highway	: NH-6 – 13.11 KM (Aerial) (W)	
Nearest Airport	NSCB (Kolkata)-101 km(Aerial) (SE)	
Protected /Reserve forest	There is no reserve forest present within 5 km.	

Prepared by:

Ultratech Environment Consultancy & laboratory

**ULTRA-TECH Environmental
Consultancy & Laboratory**
Kolkata Branch
Lab Gaztted by-MoEF-Govt. of India
An ISO 9001:2008 Certified Company
CG-229, Salt Lake Sector-II
Kolkata - 700091

FORM – A
MGAR-B-22

[See sub-rule (1) of rule 9 of West Bengal Minor Minerals (Auction) rules, 2016]

Mining Lease Area (in Ha)	: Proposed area – 2.38 hectare or 5.89 acre Permissible working area –2.38 ha (23800sqm) MGAR-B –22 (Area reduce due to Sub rule 6 of Rule 3 of W.B. MMCR/2016)										
Location of Mine (Centre)with coordinate: Location Mouza, Block, P.S. and GIS coordinates (Latitude & Longitude)of the central Axis of the mining area.	<table border="1"> <thead> <tr> <th>Latitude</th> <th>Longitude</th> </tr> </thead> <tbody> <tr> <td>22°51'36.36"N</td> <td>87°20'3.00"E</td> </tr> <tr> <td>22°51'35.12"N</td> <td>87°20'2.22"E</td> </tr> <tr> <td>22°51'42.98"N</td> <td>87°19'51.23"E</td> </tr> <tr> <td>22°51'47.07"N</td> <td>87°19'51.23"E</td> </tr> </tbody> </table> <p>Mouza- Gangani , JL no - 485,Plot no – 1(P), P.S- Garhbeta, Dist-Paschim Medinipur.</p>	Latitude	Longitude	22°51'36.36"N	87°20'3.00"E	22°51'35.12"N	87°20'2.22"E	22°51'42.98"N	87°19'51.23"E	22°51'47.07"N	87°19'51.23"E
Latitude	Longitude										
22°51'36.36"N	87°20'3.00"E										
22°51'35.12"N	87°20'2.22"E										
22°51'42.98"N	87°19'51.23"E										
22°51'47.07"N	87°19'51.23"E										
River/Canal/Khal	: Silabati River										
Topography	: Silabati River sand mining lease area covers almost a flat region. The width of the river bank varies from 15m – 35m. There is no Bridge, Dam, Hydraulic structures, railways, embankments within500 m. The other details are mentioned in the mining plan.										
Minerals of mine	: Ordinary river sand mining										
Total mineral reserves(Cum/Annum)	10. Geological Reserve in cum: 71400 Cum / Year 11. Permissible / Minerable reserve in cum : 11900 12. Production / replacement of sand in Cum per year : 11900 Cum										
Life of mine	: Thedeposition in the river bed is a regular phenomenon depends on quantum of water and the flow rate of river which varies with quantity of precipitation along the riverbed and in the catchment area also. The major portion of precipitation occurs during the monsoon period/ season i.e June to September in every year. The sand gets carried out from the upper stream of the river along the riverbed and deposited all along the riverbed, as soon as the river water current subsides. The deposit of sand is a cyclic and replenishable activity of the nature. Statutory lease can be granted upto 10 Years.										
Method of mining	: Manual										
Drilling/ Blasting	: No										
Water demand	: 3 KLD										
Sources of water	: Tube well										
Ultimate depth of Mining	: 1.5m - 2m										

Average Man Power per day	: Category of Person Required Based on Proposed	
	Activiwise Mazdoor	No
	Sand Loading Mazdoor	20
	Sand Scraping Mazdoor	10
	Tipper Operation	2
	Tipper Helper	2
	Munshi/ Clark	2
Total	36	
Solid Waste including residual riverbed materials	: Nil	
Nearest Railway Station	: Chandrakana Road Railway Station -18.43Km (Aerial) (NW)	
Nearest State Highway/ National Highway	: NH-6 – 13.11 KM (Aerial) (W)	
Nearest Airport	NSCB (Kolkata)-101 km(Aerial) (SE)	
Protected /Reserve forest	There is no reserve forest present within 5 km.	

Prepared by:



Ultratech Environment Consultancy & laboratory

**ULTRA-TECH Environmental
Consultancy & Laboratory
Kolkata Branch**
Lab Gaztted by-MoEF-Govt. of India
An ISO 9001:2008 Certified Company
CG-229, Salt Lake Sector-II
Kolkata - 700091

FORM – A
MGAR-B-23

[See sub-rule (1) of rule 9 of West Bengal Minor Minerals (Auction) rules, 2016]

Mining Lease Area (in Ha)	: Proposed area – 2.95 hectare or 7.28 acre Permissible working area –2.95 ha (29500sqm) MGAR-B –23 (Area reduce due to Sub rule 6 of Rule 3 of W.B. MMCR/2016)										
Location of Mine (Centre)with coordinate: Location Mouza, Block, P.S. and GIS coordinates (Latitude & Longitude)of the central Axis of the mining area.	<table border="1"> <thead> <tr> <th>Latitude</th> <th>Longitude</th> </tr> </thead> <tbody> <tr> <td>22°51'35.96"N</td> <td>87°20'22.01"E</td> </tr> <tr> <td>22°51'34.89"N</td> <td>87°20'22.07"E</td> </tr> <tr> <td>22°51'34.12"N</td> <td>87°20'4.01"E</td> </tr> <tr> <td>22°51'35.87"N</td> <td>87°20'5.16"E</td> </tr> </tbody> </table> <p>Mouza- Gangani , JL no - 485,Plot no – 1(P), P.S- Garhbeta, Dist-Paschim Medinipur.</p>	Latitude	Longitude	22°51'35.96"N	87°20'22.01"E	22°51'34.89"N	87°20'22.07"E	22°51'34.12"N	87°20'4.01"E	22°51'35.87"N	87°20'5.16"E
Latitude	Longitude										
22°51'35.96"N	87°20'22.01"E										
22°51'34.89"N	87°20'22.07"E										
22°51'34.12"N	87°20'4.01"E										
22°51'35.87"N	87°20'5.16"E										
River/Canal/Khal	: Silabati River										
Topography	: Silabati River sand mining lease area covers almost a flat region. The width of the river bank varies from 15m – 35m. There is no Bridge, Dam, Hydraulic structures, railways, embankments within500 m. The other details are mentioned in the mining plan.										
Minerals of mine	: Ordinary river sand mining										
Total mineral reserves(Cum/Annum)	13. Geological Reserve in cum: 88500 Cum / Year 14. Permissible / Minerable reserve in cum : 14750 15. Production / replacement of sand in Cum per year : 14750 Cum										
Life of mine	: Thedeposition in the river bed is a regular phenomenon depends on quantum of water and the flow rate of river which varies with quantity of precipitation along the riverbed and in the catchment area also. The major portion of precipitation occurs during the monsoon period/ season i.e June to September in every year. The sand gets carried out from the upper stream of the river along the riverbed and deposited all along the riverbed, as soon as the river water current subsides. The deposit of sand is a cyclic and replenishable activity of the nature. Statutory lease can be granted upto 10 Years.										
Method of mining	: Manual										
Drilling/ Blasting	: No										
Water demand	: 3 KLD										
Sources of water	: Tube well										
Ultimate depth of Mining	: 1.5m - 2m										

Average Man Power per day	: Category of Person Required Based on Proposed	
	Activiwise Mazdoor	No
	Sand Loading Mazdoor	20
	Sand Scraping Mazdoor	10
	Tipper Operation	2
	Tipper Helper	2
	Munshi/ Clark	2
Total	36	
Solid Waste including residual riverbed materials	: Nil	
Nearest Railway Station	: Chandrakana Road Railway Station -18.43Km (Aerial) (NW)	
Nearest State Highway/ National Highway	: NH-6 – 13.11 KM (Aerial) (W)	
Nearest Airport	NSCB (Kolkata)-101 km(Aerial) (SE)	
Protected /Reserve forest	There is no reserve forest present within 5 km.	

Prepared by:



Ultratech Environment Consultancy & laboratory

**ULTRA-TECH Environmental
Consultancy & Laboratory**
Kolkata Branch
Lab Gaztted by-MoEF-Govt. of India
An ISO 9001:2008 Certified Company
CG-229, Salt Lake Sector-II
Kolkata - 700091

FORM – A
MGAR-B-24

[See sub-rule (1) of rule 9 of West Bengal Minor Minerals (Auction) rules, 2016]

Mining Lease Area (in Ha)	: Proposed area – 2.30 hectare or 5.70 acre Permissible working area –2.30 ha (23000sqm) MGAR-B –24 (Area reduce due to Sub rule 6 of Rule 3 of W.B. MMCR/2016)										
Location of Mine (Centre)with coordinate: Location Mouza, Block, P.S. and GIS coordinates (Latitude & Longitude)of the central Axis of the mining area.	<table border="1"> <thead> <tr> <th>Latitude</th> <th>Longitude</th> </tr> </thead> <tbody> <tr> <td>22°51'10.77"N</td> <td>87°17'17.83"E</td> </tr> <tr> <td>22°51'9.13"N</td> <td>87°17'19.79"E</td> </tr> <tr> <td>22°51'3.39"N</td> <td>87°17'14.54"E</td> </tr> <tr> <td>22°51'5.38"N</td> <td>87°17'11.25"E</td> </tr> </tbody> </table> <p>Mouza- Bhattagram , JL no - 399,Plot no – 680(P), P.S-Garhbeta, Dist-Paschim Medinipur.</p>	Latitude	Longitude	22°51'10.77"N	87°17'17.83"E	22°51'9.13"N	87°17'19.79"E	22°51'3.39"N	87°17'14.54"E	22°51'5.38"N	87°17'11.25"E
Latitude	Longitude										
22°51'10.77"N	87°17'17.83"E										
22°51'9.13"N	87°17'19.79"E										
22°51'3.39"N	87°17'14.54"E										
22°51'5.38"N	87°17'11.25"E										
River/Canal/Khal	: Silabati River										
Topography	: Silabati River sand mining lease area covers almost a flat region. The width of the river bank varies from 15m – 35m. There is no Bridge, Dam, Hydraulic structures, railways, embankments within500 m. The other details are mentioned in the mining plan.										
Minerals of mine	: Ordinary river sand mining										
Total mineral reserves(Cum/Annum)	16. Geological Reserve in cum: 69000 Cum / Year 17. Permissible / Minerable reserve in cum : 11500 18. Production / replacement of sand in Cum per year : 11500 Cum										
Life of mine	: Thedeposition in the river bed is a regular phenomenon depends on quantum of water and the flow rate of river which varies with quantity of precipitation along the riverbed and in the catchment area also. The major portion of precipitation occurs during the monsoon period/ season i.e June to September in every year. The sand gets carried out from the upper stream of the river along the riverbed and deposited all along the riverbed, as soon as the river water current subsides. The deposit of sand is a cyclic and replenishable activity of the nature. Statutory lease can be granted upto 10 Years.										
Method of mining	: Manual										
Drilling/ Blasting	: No										
Water demand	: 3 KLD										
Sources of water	: Tube well										
Ultimate depth of Mining	: 1.5m - 2m										

Average Man Power per day	: Category of Person Required Based on Proposed	
	Activiwise Mazdoor	No
	Sand Loading Mazdoor	20
	Sand Scraping Mazdoor	10
	Tipper Operation	2
	Tipper Helper	2
	Munshi/ Clark	2
Total	36	
Solid Waste including residual riverbed materials	: Nil	
Nearest Railway Station	: Chandrakana Road Railway Station -18.43Km (Aerial) (NW)	
Nearest State Highway/ National Highway	: NH-6 – 13.11 KM (Aerial) (W)	
Nearest Airport	NSCB (Kolkata)-101 km(Aerial) (SE)	
Protected /Reserve forest	There is no reserve forest present within 5 km.	

Prepared by:



Ultratech Environment Consultancy & laboratory

**ULTRA-TECH Environmental
Consultancy & Laboratory
Kolkata Branch**
Lab Gaztted by-MoEF-Govt. of India
An ISO 9001:2008 Certified Company
CG-229, Salt Lake Sector-II
Kolkata - 700091

FORM – A
MGAR-B-25

[See sub-rule (1) of rule 9 of West Bengal Minor Minerals (Auction) rules, 2016]

Mining Lease Area (in Ha)	: Proposed area – 0.80 hectare or 1.98 acre Permissible working area –0.80 ha (8000sqm) MGAR-B –25 (Area reduce due to Sub rule 6 of Rule 3 of W.B. MMCR/2016)										
Location of Mine (Centre)with coordinate: Location Mouza, Block, P.S. and GIS coordinates (Latitude & Longitude)of the central Axis of the mining area.	<table border="1"> <thead> <tr> <th>Latitude</th> <th>Longitude</th> </tr> </thead> <tbody> <tr> <td>22°51'13.92"N</td> <td>87°17'25.79"E</td> </tr> <tr> <td>22°51'13.29"N</td> <td>87°17'26.16"E</td> </tr> <tr> <td>22°51'10.33"N</td> <td>87°17'21.37"E</td> </tr> <tr> <td>22°51'12.31"N</td> <td>87°17'20.09"E</td> </tr> </tbody> </table> <p>Mouza- Bhattagram , JL no - 399,Plot no – 680(P), P.S-Garhbeta, Dist-Paschim Medinipur.</p>	Latitude	Longitude	22°51'13.92"N	87°17'25.79"E	22°51'13.29"N	87°17'26.16"E	22°51'10.33"N	87°17'21.37"E	22°51'12.31"N	87°17'20.09"E
Latitude	Longitude										
22°51'13.92"N	87°17'25.79"E										
22°51'13.29"N	87°17'26.16"E										
22°51'10.33"N	87°17'21.37"E										
22°51'12.31"N	87°17'20.09"E										
River/Canal/Khal	: Silabati River										
Topography	: Silabati River sand mining lease area covers almost a flat region. The width of the river bank varies from 15m – 35m. There is no Bridge, Dam, Hydraulic structures, railways, embankments within500 m. The other details are mentioned in the mining plan.										
Minerals of mine	: Ordinary river sand mining										
Total mineral reserves(Cum/Annum)	19. Geological Reserve in cum: 24000 Cum / Year 20. Permissible / Minerable reserve in cum : 4000 21. Production / replacement of sand in Cum per year : 4000 Cum										
Life of mine	: Thedeposition in the river bed is a regular phenomenon depends on quantum of water and the flow rate of river which varies with quantity of precipitation along the riverbed and in the catchment area also. The major portion of precipitation occurs during the monsoon period/ season i.e June to September in every year. The sand gets carried out from the upper stream of the river along the riverbed and deposited all along the riverbed, as soon as the river water current subsides. The deposit of sand is a cyclic and replenishable activity of the nature. Statutory lease can be granted upto 10 Years.										
Method of mining	: Manual										
Drilling/ Blasting	: No										
Water demand	: 3 KLD										
Sources of water	: Tube well										

Ultimate depth of Mining	: 1.5m - 2m	
Average Man Power per day	: Category of Person Required Based on Proposed	
	Activiwise Mazdoor	No
	Sand Loading Mazdoor	20
	Sand Scraping Mazdoor	10
	Tipper Operation	2
	Tipper Helper	2
	Munshi/ Clark	2
Total	36	
Solid Waste including residual riverbed materials	: Nil	
Nearest Railway Station	: Chandrakana Road Railway Station -18.43Km (Aerial) (NW)	
Nearest State Highway/ National Highway	: NH-6 – 13.11 KM (Aerial) (W)	
Nearest Airport	NSCB (Kolkata)-101 km(Aerial) (SE)	
Protected /Reserve forest	There is no reserve forest present within 5 km.	

Prepared by:



Ultratech Environment Consultancy & laboratory

**ULTRA-TECH Environmental
Consultancy & Laboratory**
Kolkata Branch
Lab Gaztted by-MoEF-Govt. of India
An ISO 9001:2008 Certified Company
CG-229, Salt Lake Sector-II
Kolkata - 700091

FORM – A
MGAR-B-26

[See sub-rule (1) of rule 9 of West Bengal Minor Minerals (Auction) rules, 2016]

Mining Lease Area (in Ha)	: Proposed area – 1.08 hectare or 2.67 acre Permissible working area –1.08 ha (10800sqm) MGAR-B –26 (Area reduce due to Sub rule 6 of Rule 3 of W.B. MMCR/2016)										
Location of Mine (Centre)with coordinate: Location Mouza, Block, P.S. and GIS coordinates (Latitude & Longitude)of the central Axis of the mining area.	<table border="1"> <thead> <tr> <th>Latitude</th> <th>Longitude</th> </tr> </thead> <tbody> <tr> <td>22°52'36.30"N</td> <td>87°24'13.97"E</td> </tr> <tr> <td>22°52'28.51"N</td> <td>87°24'12.34"E</td> </tr> <tr> <td>22°52'27.86"N</td> <td>87°24'10.56"E</td> </tr> <tr> <td>22°52'36.45"N</td> <td>87°24'13.51"E</td> </tr> </tbody> </table> <p>Mouza- Lakshyatapal , JL no - 937,Plot no – 1381(P), P.S-Garhbeta, Dist-Paschim Medinipur.</p>	Latitude	Longitude	22°52'36.30"N	87°24'13.97"E	22°52'28.51"N	87°24'12.34"E	22°52'27.86"N	87°24'10.56"E	22°52'36.45"N	87°24'13.51"E
Latitude	Longitude										
22°52'36.30"N	87°24'13.97"E										
22°52'28.51"N	87°24'12.34"E										
22°52'27.86"N	87°24'10.56"E										
22°52'36.45"N	87°24'13.51"E										
River/Canal/Khal	: Silabati River										
Topography	: Silabati River sand mining lease area covers almost a flat region. The width of the river bank varies from 15m – 35m. There is no Bridge, Dam, Hydraulic structures, railways, embankments within500 m. The other details are mentioned in the mining plan.										
Minerals of mine	: Ordinary river sand mining										
Total mineral reserves(Cum/Annum)	22. Geological Reserve in cum: 32400 Cum / Year 23. Permissible / Minerable reserve in cum : 5400 24. Production / replacement of sand in Cum per year : 5400 Cum										
Life of mine	: The deposition in the river bed is a regular phenomenon depends on quantum of water and the flow rate of river which varies with quantity of precipitation along the riverbed and in the catchment area also. The major portion of precipitation occurs during the monsoon period/ season i.e June to September in every year. The sand gets carried out from the upper stream of the river along the riverbed and deposited all along the riverbed, as soon as the river water current subsides. The deposit of sand is a cyclic and replenishable activity of the nature. Statutory lease can be granted upto 10 Years.										
Method of mining	: Manual										
Drilling/ Blasting	: No										
Water demand	: 3 KLD										
Sources of water	: Tube well										

Ultimate depth of Mining	: 1.5m - 2m	
Average Man Power per day	: Category of Person Required Based on Proposed	
	Activiwise Mazdoor	No
	Sand Loading Mazdoor	20
	Sand Scraping Mazdoor	10
	Tipper Operation	2
	Tipper Helper	2
	Munshi/ Clark	2
Total	36	
Solid Waste including residual riverbed materials	: Nil	
Nearest Railway Station	: Chandrakana Road Railway Station -18.43Km (Aerial) (NW)	
Nearest State Highway/ National Highway	: NH-6 – 13.11 KM (Aerial) (W)	
Nearest Airport	NSCB (Kolkata)-101 km(Aerial) (SE)	
Protected /Reserve forest	There is no reserve forest present within 5 km.	

Prepared by:



Ultratech Environment Consultancy & laboratory

**ULTRA-TECH Environmental
Consultancy & Laboratory**
Kolkata Branch
Lab Gaztted by-MoEF-Govt. of India
An ISO 9001:2008 Certified Company
CG-229, Salt Lake Sector-II
Kolkata - 700091

FORM – A
MGAR-B-27

[See sub-rule (1) of rule 9 of West Bengal Minor Minerals (Auction) rules, 2016]

Mining Lease Area (in Ha)	: Proposed area – 0.78 hectare or 1.93 acre Permissible working area –0.78 ha (7800sqm) MGAR-B –27 (Area reduce due to Sub rule 6 of Rule 3 of W.B. MMCR/2016)										
Location of Mine (Centre)with coordinate: Location Mouza, Block, P.S. and GIS coordinates (Latitude & Longitude)of the central Axis of the mining area.	<table border="1"> <thead> <tr> <th>Latitude</th> <th>Longitude</th> </tr> </thead> <tbody> <tr> <td>22°52'26.35"N</td> <td>87°24'12.60"E</td> </tr> <tr> <td>22°52'19.75"N</td> <td>87°24'18.10"E</td> </tr> <tr> <td>22°52'19.23"N</td> <td>87°24'17.71"E</td> </tr> <tr> <td>22°52'25.89"N</td> <td>87°24'11.01"E</td> </tr> </tbody> </table> <p>Mouza- Lakshyatapal , JL no - 937,Plot no – 1381(P), P.S-Garhbeta, Dist-Paschim Medinipur.</p>	Latitude	Longitude	22°52'26.35"N	87°24'12.60"E	22°52'19.75"N	87°24'18.10"E	22°52'19.23"N	87°24'17.71"E	22°52'25.89"N	87°24'11.01"E
Latitude	Longitude										
22°52'26.35"N	87°24'12.60"E										
22°52'19.75"N	87°24'18.10"E										
22°52'19.23"N	87°24'17.71"E										
22°52'25.89"N	87°24'11.01"E										
River/Canal/Khal	: Silabati River										
Topography	: Silabati River sand mining lease area covers almost a flat region. The width of the river bank varies from 15m – 35m. There is no Bridge, Dam, Hydraulic structures, railways, embankments within500 m. The other details are mentioned in the mining plan.										
Minerals of mine	: Ordinary river sand mining										
Total mineral reserves(Cum/Annum)	25. Geological Reserve in cum: 23400 Cum / Year 26. Permissible / Minerable reserve in cum : 3900 27. Production / replacement of sand in Cum per year : 3900 Cum										
Life of mine	: The deposition in the river bed is a regular phenomenon depends on quantum of water and the flow rate of river which varies with quantity of precipitation along the riverbed and in the catchment area also. The major portion of precipitation occurs during the monsoon period/ season i.e June to September in every year. The sand gets carried out from the upper stream of the river along the riverbed and deposited all along the riverbed, as soon as the river water current subsides. The deposit of sand is a cyclic and replenishable activity of the nature. Statutory lease can be granted upto 10 Years.										
Method of mining	: Manual										
Drilling/ Blasting	: No										
Water demand	: 3 KLD										
Sources of water	: Tube well										

Ultimate depth of Mining	: 1.5m - 2m	
Average Man Power per day	: Category of Person Required Based on Proposed	
	Activiwise Mazdoor	No
	Sand Loading Mazdoor	20
	Sand Scraping Mazdoor	10
	Tipper Operation	2
	Tipper Helper	2
	Munshi/ Clark	2
Total	36	
Solid Waste including residual riverbed materials	: Nil	
Nearest Railway Station	: Chandrakana Road Railway Station -18.43Km (Aerial) (NW)	
Nearest State Highway/ National Highway	: NH-6 – 13.11 KM (Aerial) (W)	
Nearest Airport	NSCB (Kolkata)-101 km(Aerial) (SE)	
Protected /Reserve forest	There is no reserve forest present within 5 km.	

Prepared by:



Ultratech Environment Consultancy & laboratory

**ULTRA-TECH Environmental
Consultancy & Laboratory**
Kolkata Branch
Lab Gaztted by-MoEF-Govt. of India
An ISO 9001:2008 Certified Company
CG-229, Salt Lake Sector-II
Kolkata - 700091

FORM – A
MGAR-B-28

[See sub-rule (1) of rule 9 of West Bengal Minor Minerals (Auction) rules, 2016]

Mining Lease Area (in Ha)	: Proposed area – 0.98 hectare or 2.42 acre Permissible working area –0.98 ha (9800sqm) MGAR-B –28 (Area reduce due to Sub rule 6 of Rule 3 of W.B. MMCR/2016)										
Location of Mine (Centre)with coordinate: Location Mouza, Block, P.S. and GIS coordinates (Latitude & Longitude)of the central Axis of the mining area.	<table border="1"> <thead> <tr> <th>Latitude</th> <th>Longitude</th> </tr> </thead> <tbody> <tr> <td>22°50'13.80"N</td> <td>87°15'21.30"E</td> </tr> <tr> <td>22°50'13.39"N</td> <td>87°15'21.98"E</td> </tr> <tr> <td>22°50'4.27"N</td> <td>87°15'11.18"E</td> </tr> <tr> <td>22°50'5.05"N</td> <td>87°15'10.40"E</td> </tr> </tbody> </table> <p>Mouza- Bhagar Danga , JL no - 366,Plot no – 72(P), P.S-Garhbeta, Dist-Paschim Medinipur.</p>	Latitude	Longitude	22°50'13.80"N	87°15'21.30"E	22°50'13.39"N	87°15'21.98"E	22°50'4.27"N	87°15'11.18"E	22°50'5.05"N	87°15'10.40"E
Latitude	Longitude										
22°50'13.80"N	87°15'21.30"E										
22°50'13.39"N	87°15'21.98"E										
22°50'4.27"N	87°15'11.18"E										
22°50'5.05"N	87°15'10.40"E										
River/Canal/Khal	: Silabati River										
Topography	: Silabati River sand mining lease area covers almost a flat region. The width of the river bank varies from 15m – 35m. There is no Bridge, Dam, Hydraulic structures, railways, embankments within500 m. The other details are mentioned in the mining plan.										
Minerals of mine	: Ordinary river sand mining										
Total mineral reserves(Cum/Annum)	28. Geological Reserve in cum: 29400 Cum / Year 29. Permissible / Minerable reserve in cum : 4900 30. Production / replacement of sand in Cum per year : 4900 Cum										
Life of mine	: Thedeposition in the river bed is a regular phenomenon depends on quantum of water and the flow rate of river which varies with quantity of precipitation along the riverbed and in the catchment area also. The major portion of precipitation occurs during the monsoon period/ season i.e June to September in every year. The sand gets carried out from the upper stream of the river along the riverbed and deposited all along the riverbed, as soon as the river water current subsides. The deposit of sand is a cyclic and replenishable activity of the nature. Statutory lease can be granted upto 10 Years.										
Method of mining	: Manual										
Drilling/ Blasting	: No										
Water demand	: 3 KLD										
Sources of water	: Tube well										
Ultimate depth of Mining	: 1.5m - 2m										

Average Man Power per day	: Category of Person Required Based on Proposed	
	Activiwise Mazdoor	No
	Sand Loading Mazdoor	20
	Sand Scraping Mazdoor	10
	Tipper Operation	2
	Tipper Helper	2
	Munshi/ Clark	2
Total	36	
Solid Waste including residual riverbed materials	: Nil	
Nearest Railway Station	: Chandrakana Road Railway Station -18.43Km (Aerial) (NW)	
Nearest State Highway/ National Highway	: NH-6 – 13.11 KM (Aerial) (W)	
Nearest Airport	NSCB (Kolkata)-101 km(Aerial) (SE)	
Protected /Reserve forest	There is no reserve forest present within 5 km.	

Prepared by:



Ultratech Environment Consultancy & laboratory

**ULTRA-TECH Environmental
Consultancy & Laboratory**
Kolkata Branch
Lab Gaztted by-MoEF-Govt. of India
An ISO 9001:2008 Certified Company
CG-229, Salt Lake Sector-II
Kolkata - 700091

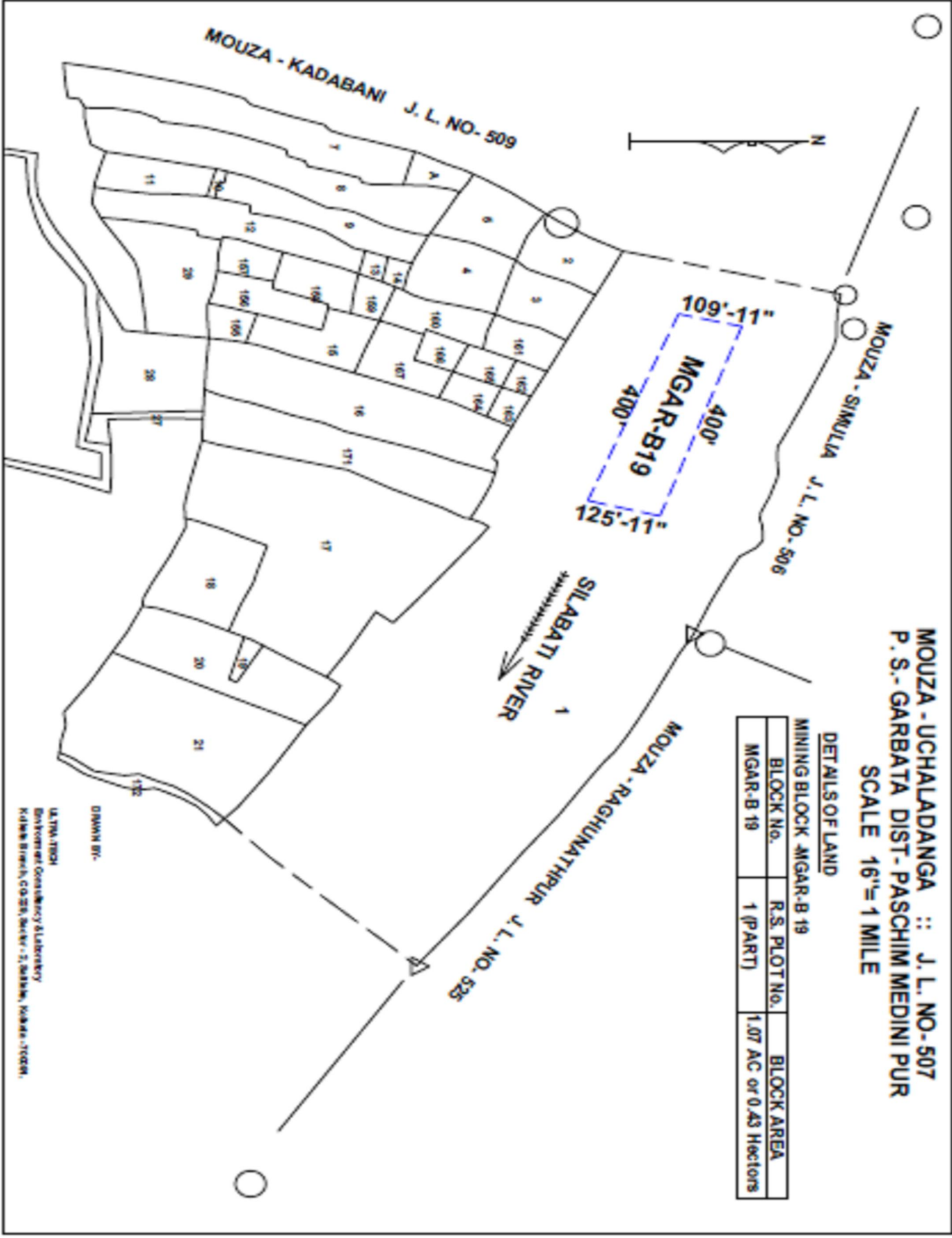

MOUZA - UCHALADANGA :: J. L. NO-507
P. S.- GARBATA DIST- PASCHIM MEDINI PUR
SCALE 16"= 1 MILE

DETAILS OF LAND

MINING BLOCK -MGAR-B 19

BLOCK No.	R.S. PLOT No.	BLOCK AREA
MGAR-B 19	1 (PART)	1.07 AC or 0.43 Hectors

U.T.M.A.TECH
 Environmet Consultancy Laboratory
 K-10/4, Block-1, G-2/5, Sector-5, Gurgaon, Haryana-122001.